

5. Kobe International Conference Center

Meeting Room Only (Free Wi-Fi LAN Spot)

1F

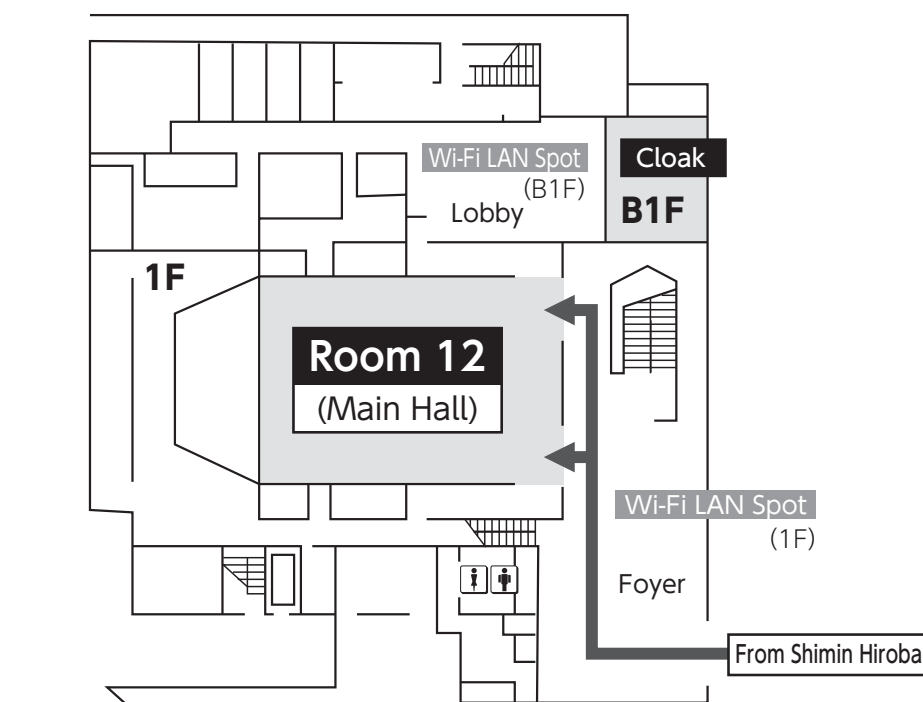

To reach Room 12, use the accessway of Kobe International Conference Center 2F

2F

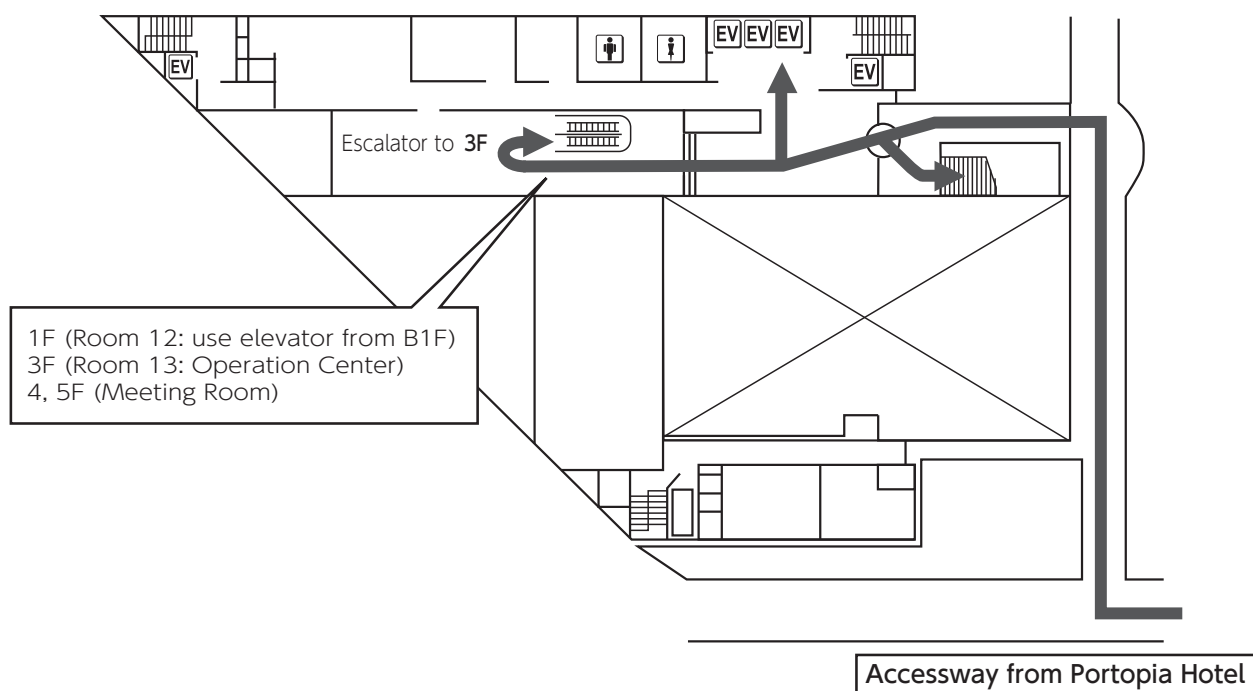

1F (Room 12: use elevator from B1F)
 3F (Room 13: Operation Center)
 4, 5F (Meeting Room)

Accessway from Portopia Hotel

5. Kobe International Conference Center

3F

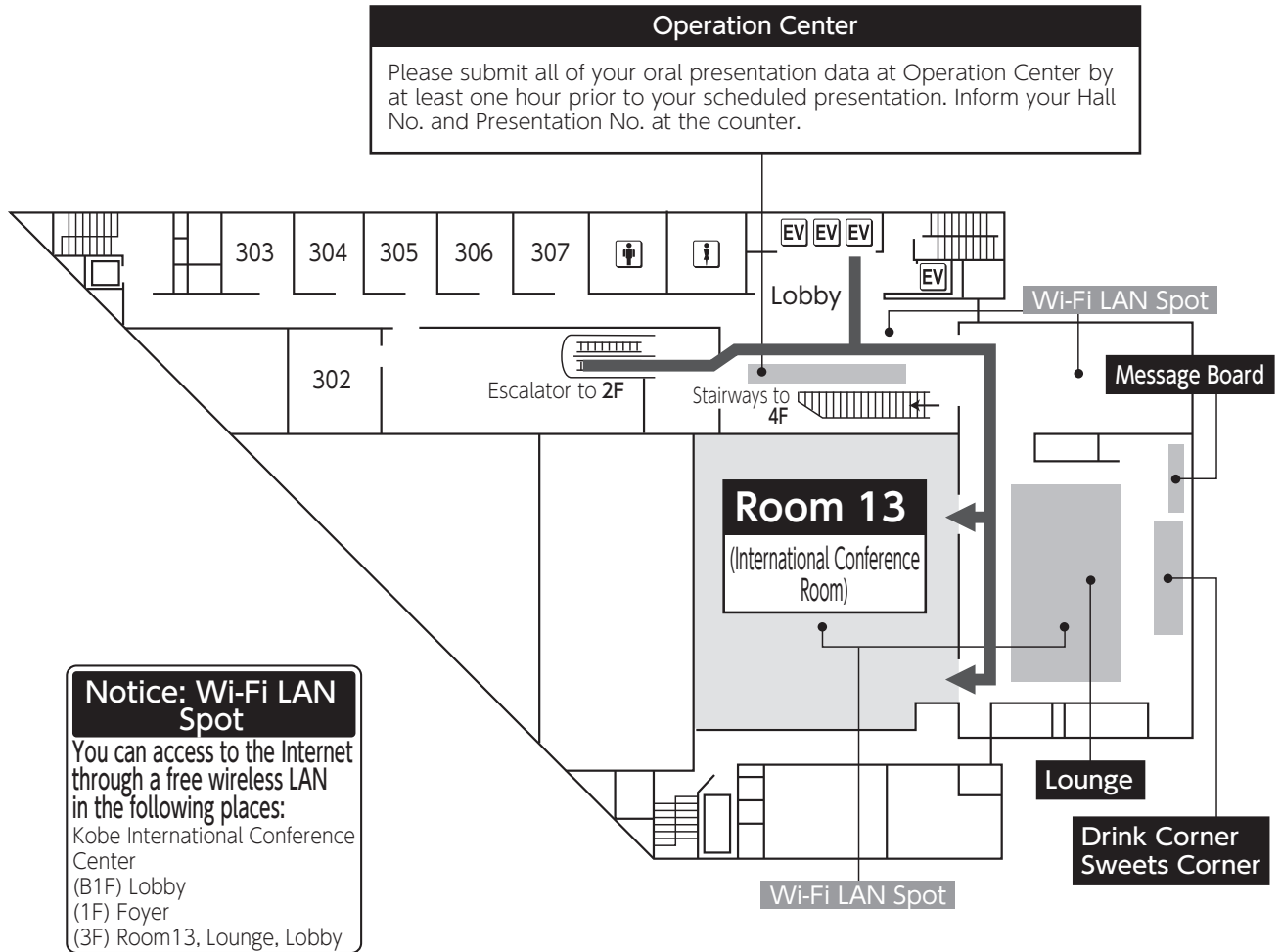

Sweets Corner

During the conference period, we will open a sweets corner (offering baked confections unique to Kobe) by offering by Kobe City.

Day & Hours: November 1 (Thu) to November 3 (Sat), 9:00-17:00

Place: Kobe International Conference Center 3F in front of Room 13
(International Conference Room)

*Please note that the number of the sweets is limited.

5. Kobe International Conference Center

Meeting Room Only (Free Wi-Fi LAN Spot)

4F

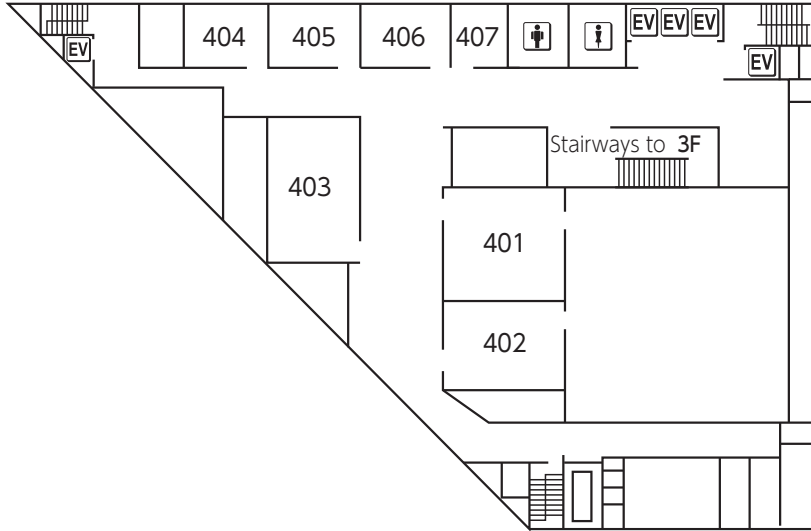

5F

